

The Arroyo Market Square



SWC I-215 & Rainbow
Opening 3rd. Quarter of 2007



The Arroyo Market Square is a 940,000 square foot retail power center, which is located adjacent to the Arroyo Corporate Center, a 1.5 million square foot Class "A" office development. The Arroyo Market Square will be home to many national big-box tenants, as well as in-line shop tenants, and will feature a variety of casual dining selections. This new development will provide excellent visibility to people enjoying their new Beltway commute. Now is your opportunity to become a part of this rapidly growing area. With the excellent freeway accessibility offered by this site, retailers will not only draw customers from the southwest, they will also enjoy business from the Summerlin area as well.

Kit Graski
Senior Vice President

Rhonda Pchola
Sales & Leasing Specialist

Voit Commercial Brokerage
10100 W. Charleston Blvd., Suite 200
Las Vegas NV 89135
702-734-4500 ph
702-733-7690 fax



Located at the southwest corner of I-215 & Rainbow, this project is being developed by Laurich Properties and EJM Development Co. Since 1993, Laurich Properties has been responsible for more than three million square feet of new retail space in Southern Nevada, including more than two dozen neighborhood and power shopping centers.

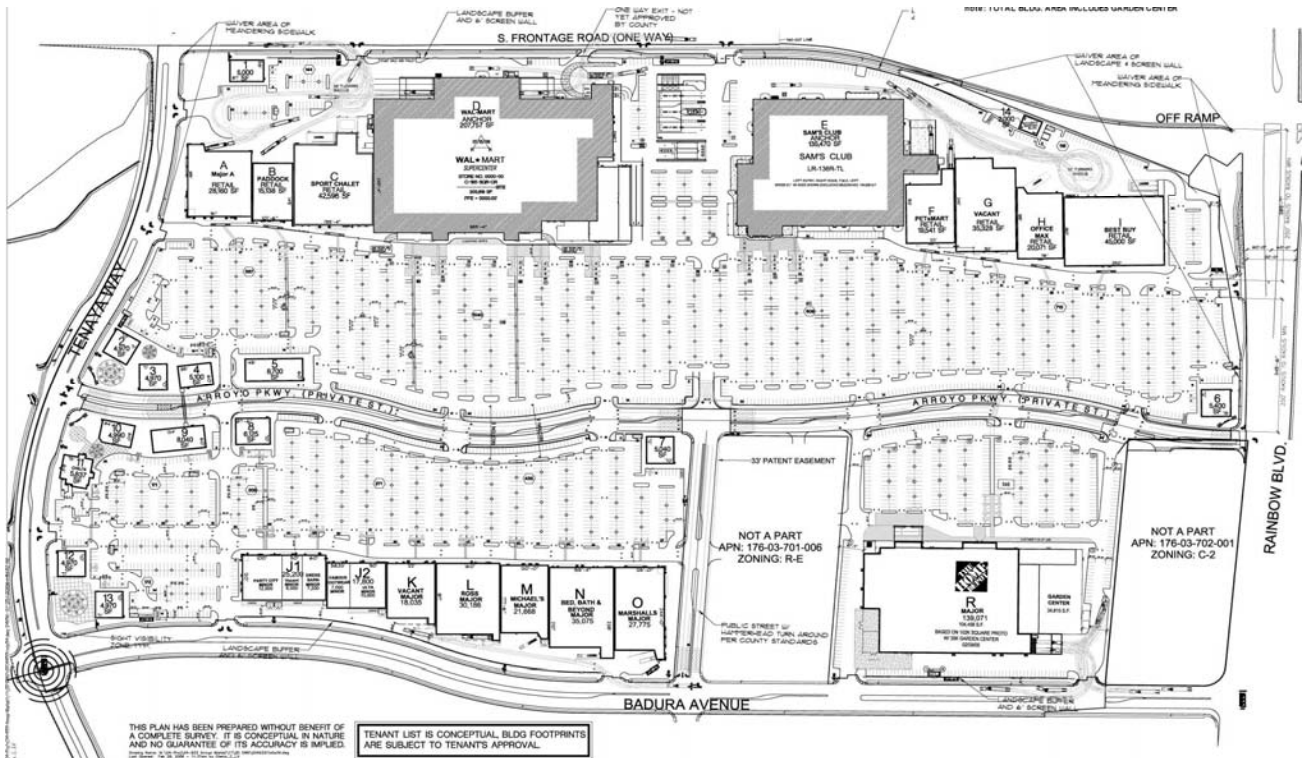

EJM Development Co. was formed in 1973 to acquire, develop and manage industrial, commercial and residential properties. Since then, the company has grown to its current status as one of the leading industrial/commercial developers in the western states of California, Nevada, Arizona, New Mexico and Utah.