

Property Information

± 932,752 sf Gross Land Area
 ± 21.41 Acres (Gross)
 ± 871,986 sf Net Land Area
 ± 2002 Acres (Net)
 197,682 sf Total Building Area
 341/1 (22.67%) Floor Area Ratio (F.A.R.)
 1,140 Stalls Total Parking Provided
 791 Stalls Total Parking Required
 5.77 Stalls/1000 sf Parking Ratio

The parking required calculations are based upon the following:
 Retail: 4/1000

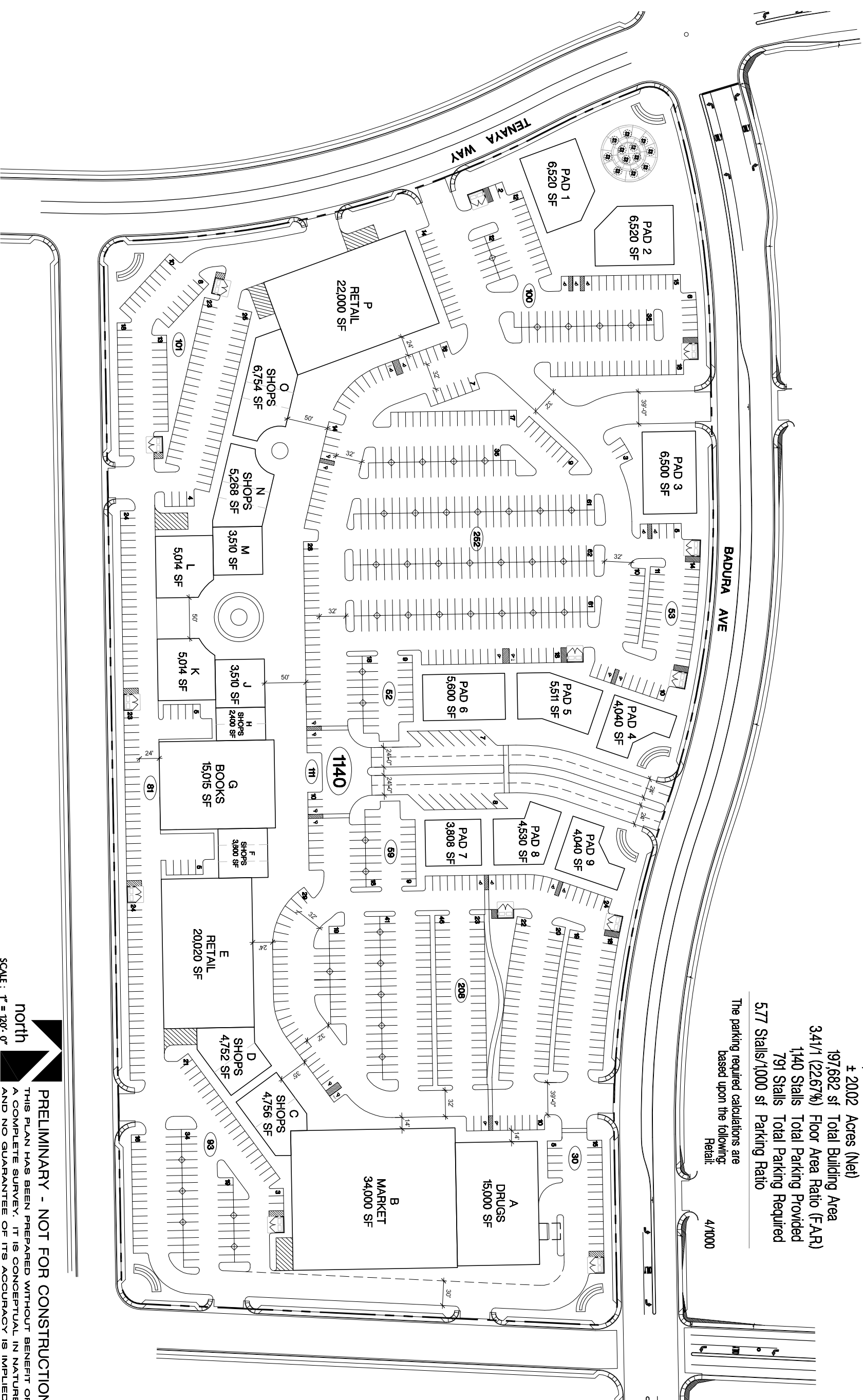

ARCHITECTURAL DESIGN SITE PLAN

PRELIMINARY - NOT FOR CONSTRUCTION
 THIS PLAN HAS BEEN PREPARED WITHOUT BENEFIT OF A COMPLETE SURVEY. IT IS CONCEPTUAL IN NATURE, AND NO GUARANTEE OF ITS ACCURACY IS IMPLIED.

Scale: 1" = 120'-0"

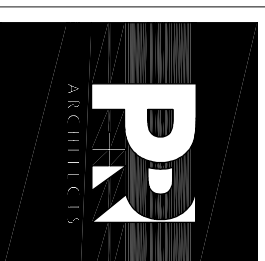

3980 Howard Hughes Pkwy.
 Suite 490
 Las Vegas, NV 89109
 702-892-8500
 702-892-8514 fax
 www.prarchitects.com
 Corporate Office:
 Long Beach, CA
 Regional Offices:
 Newport Beach CA
 Washington, DC
 Las Vegas, NV
 Portland, OR
 Rogers, AR

ETM
 DEVELOPMENT CO
 3550 East Post Road
 Suite 200
 Las Vegas, NV 89120
 702-597-1852

Perkowitz + Ruth
 ARCHITECTS
 SEC of Tenaya Way & Badura Ave.
 Las Vegas,
 Nevada

Revisions

		08/03/06

Date: 03/09/06
 Drawn By: SAJ
 Checked By: DM
 Project No: 06-145-ft
 File Name: D06145.rstsite05.dwg
 Scale: 1" = 120'

Site Plan
05