

THE ARROYO



Experience

The Arroyo Corporate Center

The Arroyo Corporate Center is the premier master-planned mixed-use development located in the southwest submarket of the valley. This superbly conceived 450-acre project incorporates every element to provide unsurpassed tenant satisfaction in a state-of-the-art corporate environment. The Arroyo Corporate Center offers a full spectrum of business location options, including Class A office buildings, ranging from two (2) to six (6) stories, single story office and industrial buildings. Located adjacent to the Corporate Center is the Arroyo Market Square, a 900,000 square foot retail power center which will include a wide variety of restaurants. With these unprecedented amenities on-site, the Arroyo Corporate Center is the premier office development in Las Vegas.

For More Information Call:

Randy Broadhead, SIOR
Senior Vice President
702.369.4867
randy.broadhead@cbre.com

Brad Peterson, SIOR
Senior Vice President
702.369.4809
brad.peterson@cbre.com

- Part of a 450-acre master-planned business park that will offer over 5 million square feet of office, industrial and retail space
- Phase A will offer two (2) Class A office buildings totaling +/- 125,000 square feet
- Abundant parking available
- Ideal southwest location, centrally located between Summerlin and Green Valley
- Preleasing incentives for the first tenants
- Convenient access as well as visibility from the I-215 Beltway
- Close proximity to McCarran International Airport
- Integrated architectural and landscape concepts throughout the park
- Distinctive project signage
- Lush landscaped green belts, wide streets and extensive tree-lined water features and paths, utilizing the beauty of the existing arroyos



For More Information Call:

Randy Broadhead, SIOR
Senior Vice President
702.369.4867
randy.broadhead@cbre.com

Brad Peterson, SIOR
Senior Vice President
702.369.4809
brad.peterson@cbre.com

PHASE A

BUILDING 1 ± 50,000 SF
BUILDING 2 ± 70,000 SF

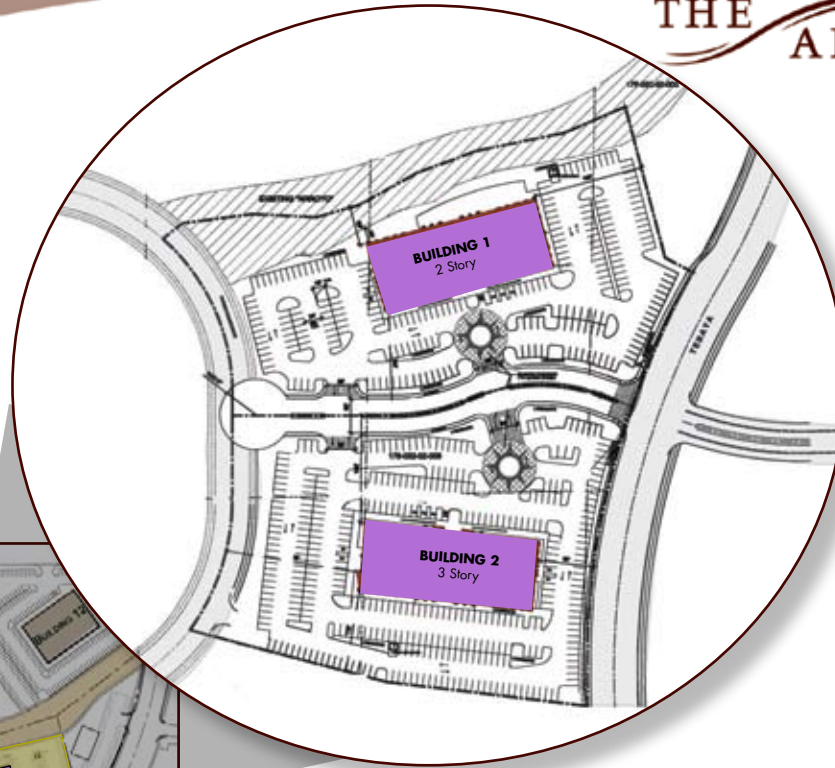
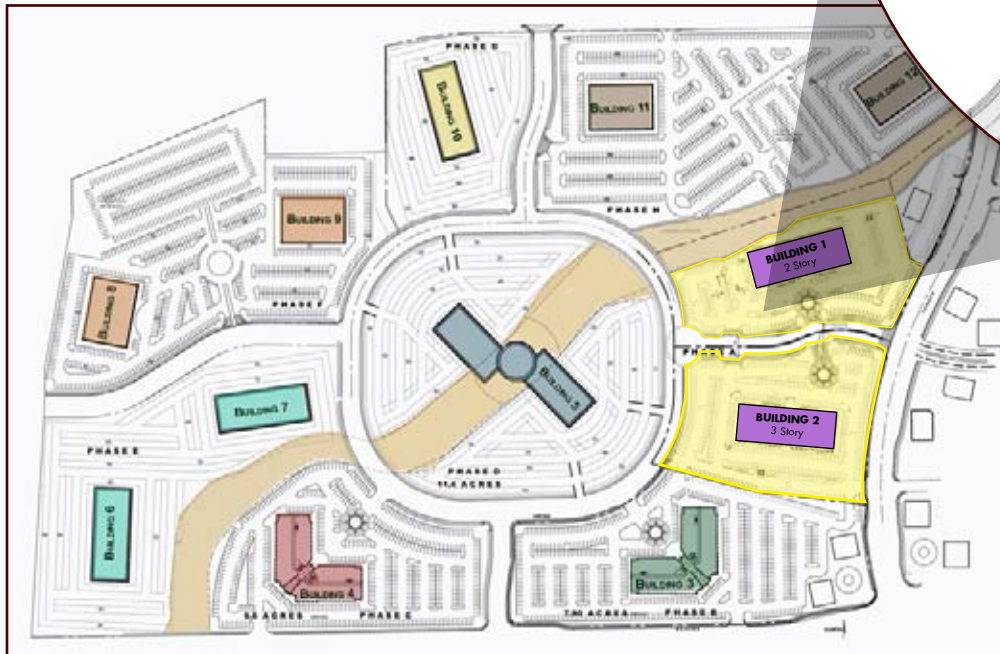

For More Information Call:

Randy Broadhead, SIOR
Senior Vice President
702.369.4867
randy.broadhead@cbre.com

Brad Peterson, SIOR
Senior Vice President
702.369.4809
brad.peterson@cbre.com

PHASE B

BUILDING 3 ±100,000 SF

PHASE C

BUILDING 3 ±100,000 SF

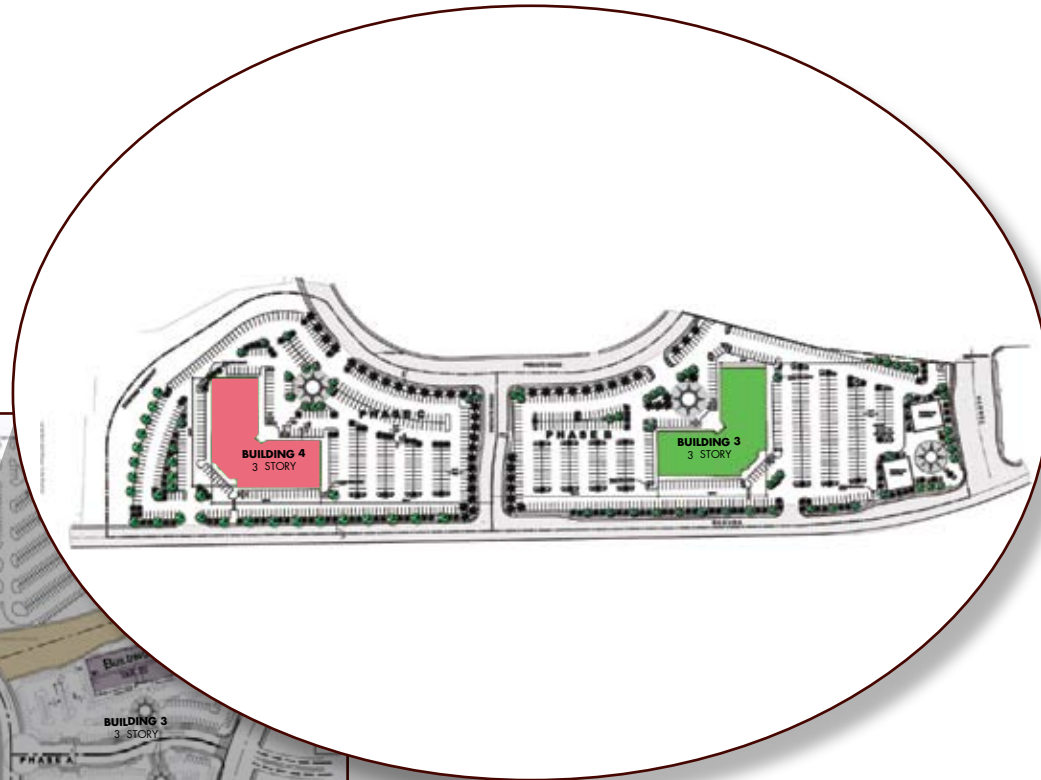
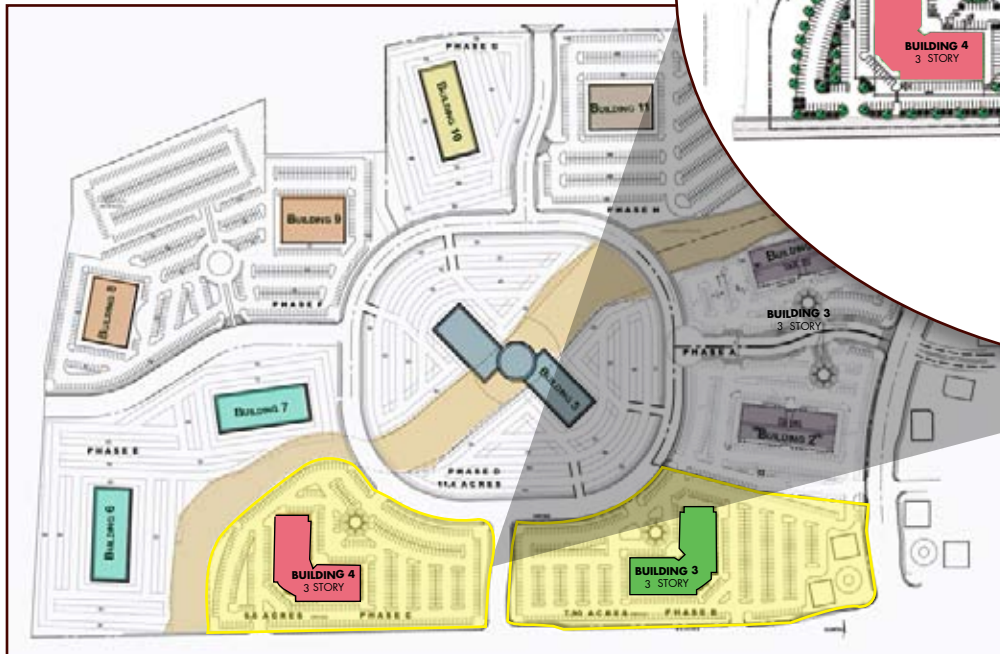

For More Information Call:

Randy Broadhead, SIOR
Senior Vice President
702.369.4867
randy.broadhead@cbre.com

Brad Peterson, SIOR
Senior Vice President
702.369.4809
brad.peterson@cbre.com